



Part Number: D4C4080Y

Electrical Specifications

| | |
|------------------------|------------------------|
| Frequency Range (GHz): | 4.0 – 8.0 |
| Isolation (dB): | 16 MIN (per junction) |
| Insertion Loss (dB): | 0.8 MAX (per junction) |
| Return Loss (dB): | 16 MIN (per junction) |
| Forward Power (W): | 20 AVG 30 PK |

Mechanical/Environmental Specifications

| | |
|-------------------|----------------------------|
| Connector Type: | SMA |
| Connector Body: | Passivated stainless steel |
| Connector Pin: | Gold plated copper |
| Load Body: | Brass |
| Magnetic Shunt: | Nickel plated CRS |
| Operational Temp: | < 77K |
| Weight (oz) | 4.0 MAX |

D4C4080Y

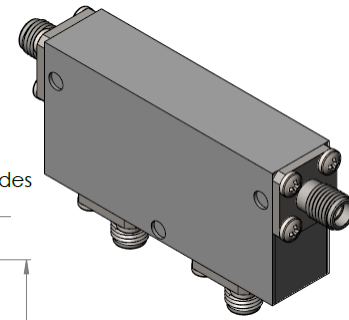
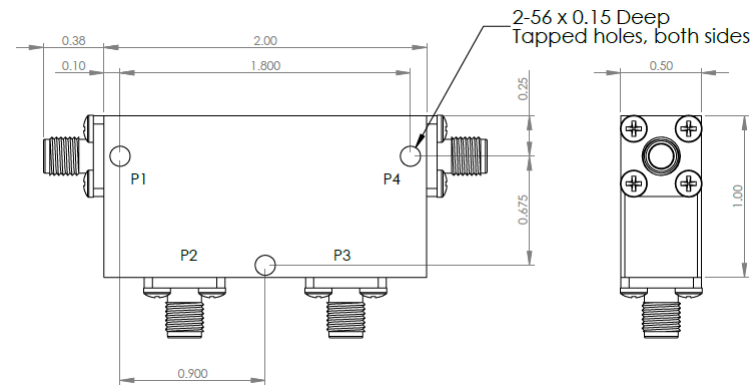

D4C4080Y-3

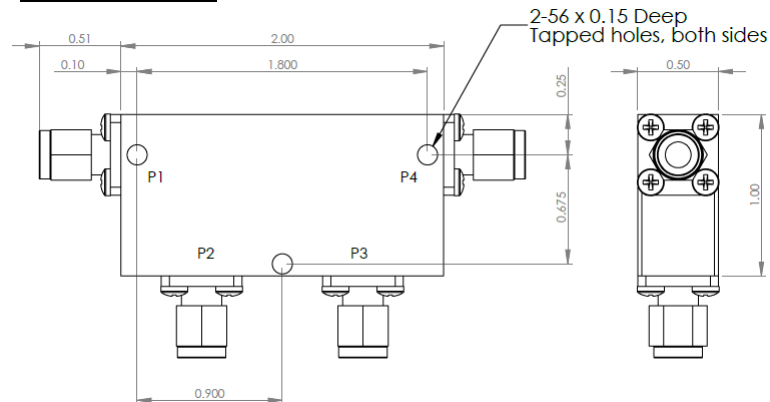

Dimensions are in inches
Tolerance
XX ±0.03
XXX ±0.010

| Type of Device | PN Suffix | Connector Configuration Input / Output | PN Example |
|--|-----------|---|------------|
| Dual Junction Circulator 4-Port Device Port 1 / Port 2 / Port 3 / Port 4 | No Dash | Female / Female / Female / Female | D4C4080Y |
| | -1 | Male / Female / Female / Female | D4C4080Y-1 |
| | -2 | Female / Male / Female / Female | D4C4080Y-2 |
| | -3 | Male / Male / Male / Male | D4C4080Y-3 |
| | -4 | Female / Female / Male / Female | D4C4080Y-4 |
| | -5 | Female / Female / Female / Male | D4C4080Y-5 |

MEASURED DATA

Part Number: D4C4080Y, P4→P1, P2 & P3 Terminated with 50Ω, Measured at 77K

